

# Polygrip Recessed Serrated Bushing

## Bushings for Composites – Drilling and Locating

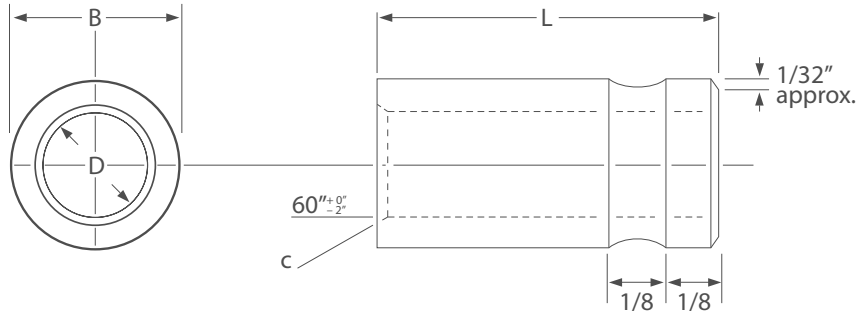

### KEY FEATURES

- / Ground bores
- / Resin groove
- / Chamfered entry

### APPLICATION

Serrated bushings are common place in glass fibre, composite or synthetic jigs. The serrations and grooved recess lock the bushing in place and prevent axial movement. Unlike regular drill bushings, serrated bushings are not to tight tolerance unless requested.

The grooved recess feature of our GS bushings allows for resin based materials to run into the channel and set the bush in place.

### ORDERING INSTRUCTIONS

Identify the Bushing ID required and length. Part codes are the Bushing reference plus the diameter. For example: GS14-5/16"

### NOTES

Boneham Bushing codes ranging from GS1 to GS15. Drill bushing drill diameters from 1.6mm to 9.5mm. Maximum eccentricity 0.003.



Bushing Reference	"Bore Diameter D"			Limits of Tolerance	Outside Diameter of Body B	Depth of Chamfer C	Length L
	From	To					
GS1	1/16	1/8		+0.0005	1/4	1/64	3/8
GS2	1.6mm	3.45mm		+0.0015	1/4	1/64	1/2
GS3					1/4	1/64	3/4
GS4	3/32	3/16		+0.0005	3/8	1/32	3/8
GS5	3.45mm	4.9mm		+0.0015	3/8	1/32	1/2
GS6					3/8	1/32	3/4
GS7	3/16	1/4		+0.001	7/16	1/32	3/8
GS8	4.95mm	6.5mm		+0.002	7/16	1/32	1/2
GS9					7/16	1/32	3/4
GS10	1/4	5/16		+0.001	1/2	3/64	3/8
GS11	6.4mm	7.9mm		+0.002	1/2	3/64	1/2
GS12					1/2	3/64	3/4
GS13	5/16	13/32		+0.001	5/8	3/64	3/8
GS14	8.0mm	10.5mm		+0.002	5/8	3/64	1/2
GS15					5/8	3/64	3/4

Unless otherwise stated, dimensions and tolerances shown in Inches. Maximum eccentricity 0.003.